

Communicator 5 Accessible Apps - Accessible Google Translate: Quick Guide

This document provides instructions on how to use the Accessible Google Translate App to translate messages into a target language that is supported by Google Translate.

Requirements: An unlocked device with access to the internet is required.

Note: Refer to the **Getting Started with Communicator 5 Accessible Apps Quick Guide** for instructions on how to set up Communicator 5 Home Page with the accessible apps collection.

Launch Accessible Google Translate



Launch Communicator 5

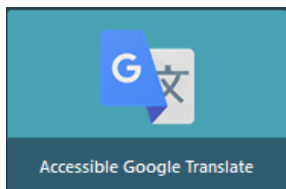

On Communicator 5 Home Page, select Accessible Google Translate to launch

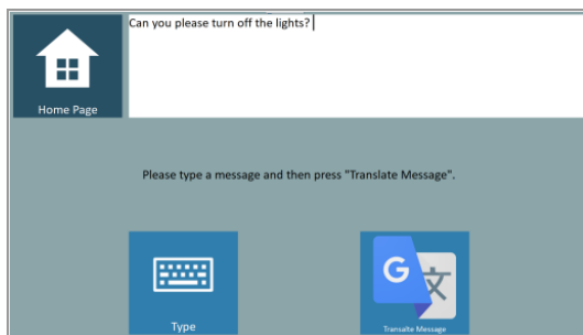

Accessible Google Translate Home Page

- **Type** – Opens the Communicator 5 keyboard for typing a message to translate
- **Translate Message** – Opens Translate page (refer to **Accessible Google Translate Page** below)
- **Home Page** – Exit Accessible Google Translate to user's Communicator 5 home page

Accessible Google Translate Page

After selecting Translate Message, Accessible Google Translate navigates to the Translate page.

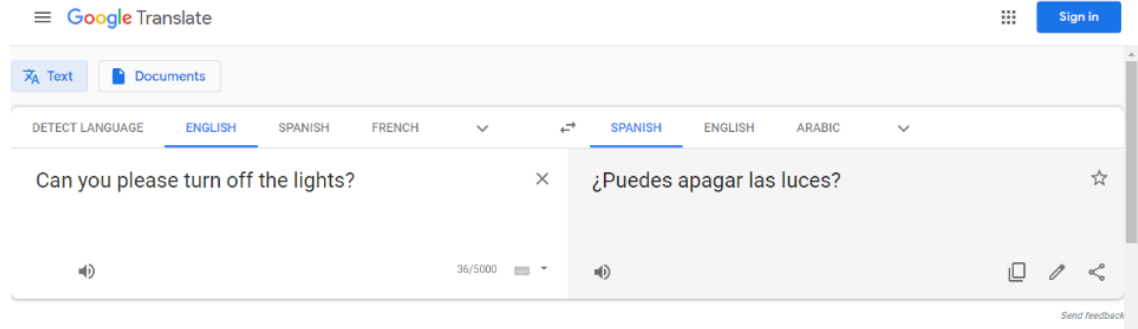

Select the language for the message, if different from the auto-detected language (refer to **Select Language Page** below)

Select the language the message will be translated to (refer to **Select Language Page** below)

Swap the source and the target language

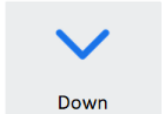
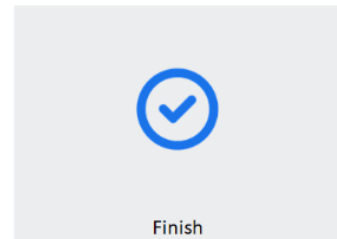
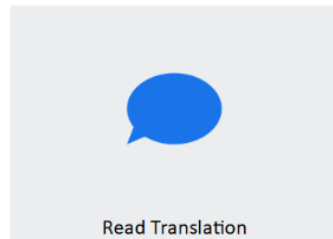
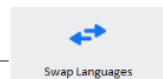

Read the translation aloud using Google Translate for languages that are supported (not using Communicator 5 voices)

Navigate back to Google Translate Home Page

Browse up and down translations in cases where Google Translate offers more than one translation

Select Language Page

Following selection of **Select Source Language** or **Select Target Language** from the Google Translate Page the Select Language Page will open to allow the user to choose from the language supported by Google Translate. These options are dwell enabled for the user to select with eye gaze.

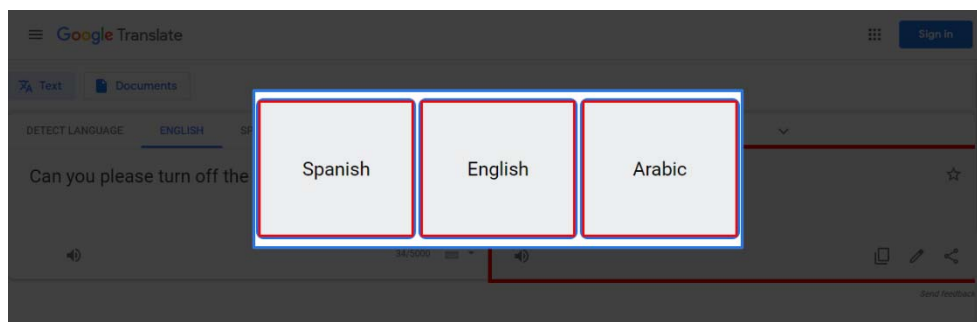

Navigate back to the Google Translate Page

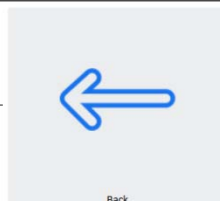

Navigate to a list of all languages supported by Google Translate, use the **Select** button to make options dwell enabled for selection with eye gaze